

# STAGE C

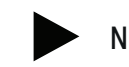

SIZE / TYPE

6500sf. / Dark Stage



SPECS

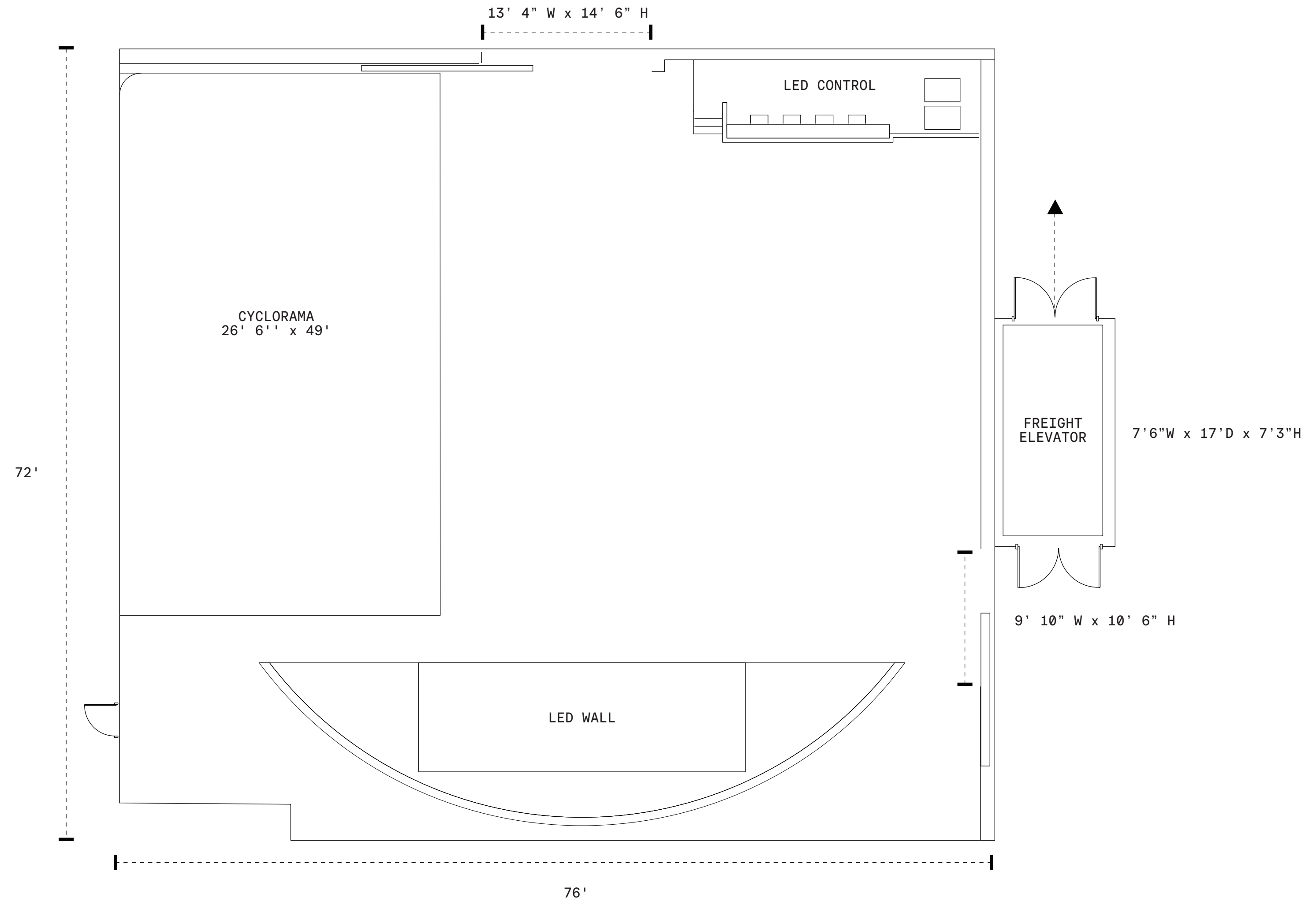

Dimensions: 78'W x 85'D x 31.5'H to Beams / 45' to the Ceiling / 20'H to the Grid Over the Cyc  
 Cyclorama: Two Wall, One Corner 49'W x 26'6"D x 20'H Back Wall x 14'6"H Wall on Right  
 Stage Door To: Freight Area 9'10"W x 10'6"H / Reception Area 13'4"W x

14'6"H  
 Power: 600 Amps 3 Phase Distributed by One 200 Amp & One 400 Amp  
 3 Phase Camlocks  
 Vehicle Accessible

# STAGE C



SIZE / TYPE

6500sf. / Dark Stage



SPECS

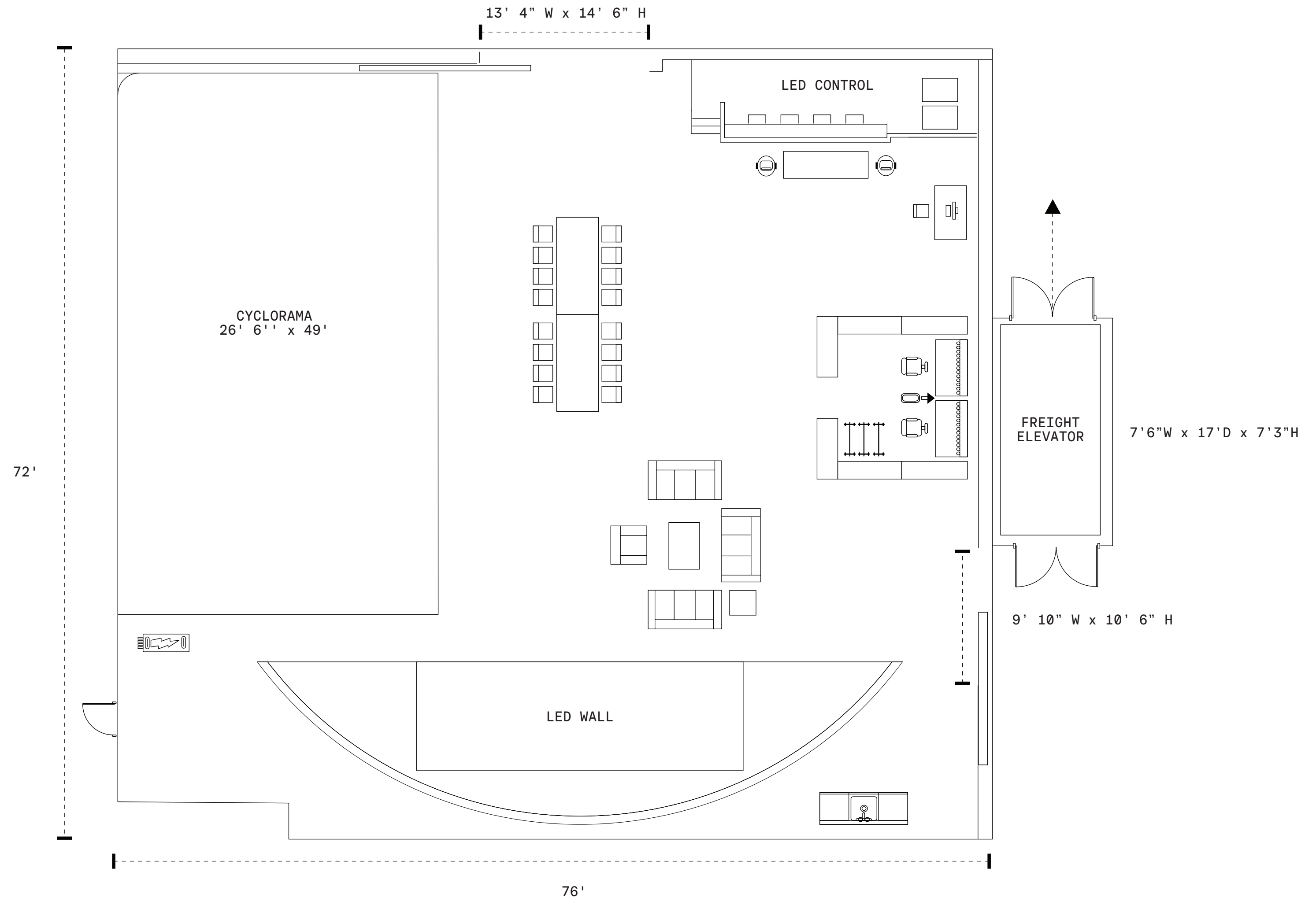

Dimensions: 78'W x 85'D x 31.5'H to Beams / 45' to the Ceiling / 20'H to the Grid Over the Cyc  
 Cyclorama: Two Wall, One Corner 49'W x 26'6"D x 20'H Back Wall x 14'6"H Wall on Right  
 Stage Door To: Freight Area 9'10"W x 10'6"H / Reception Area 13'4"W x

14'6"H  
 Power: 600 Amps 3 Phase Distributed by One 200 Amp & One 400 Amp  
 3 Phase Camlocks  
 Vehicle Accessible