

# STUDIO 10



SIZE / TYPE

4150sf. / Western Daylight Studio

SPECS

Dimensions: 69'W x 69'D x 11'8"H to Beams / 15'-18' Slope of Ceiling  
 East Cyclorama: One Wall, 21'W x 21'6"D x 12'6"H  
 West Cyclorama: One Wall with Return, 23'W x 27'7"D x 13'H to Top of Cove  
 West Facing Windows: Wall of Three, 17'9"W x 10'H / Blackout Capable

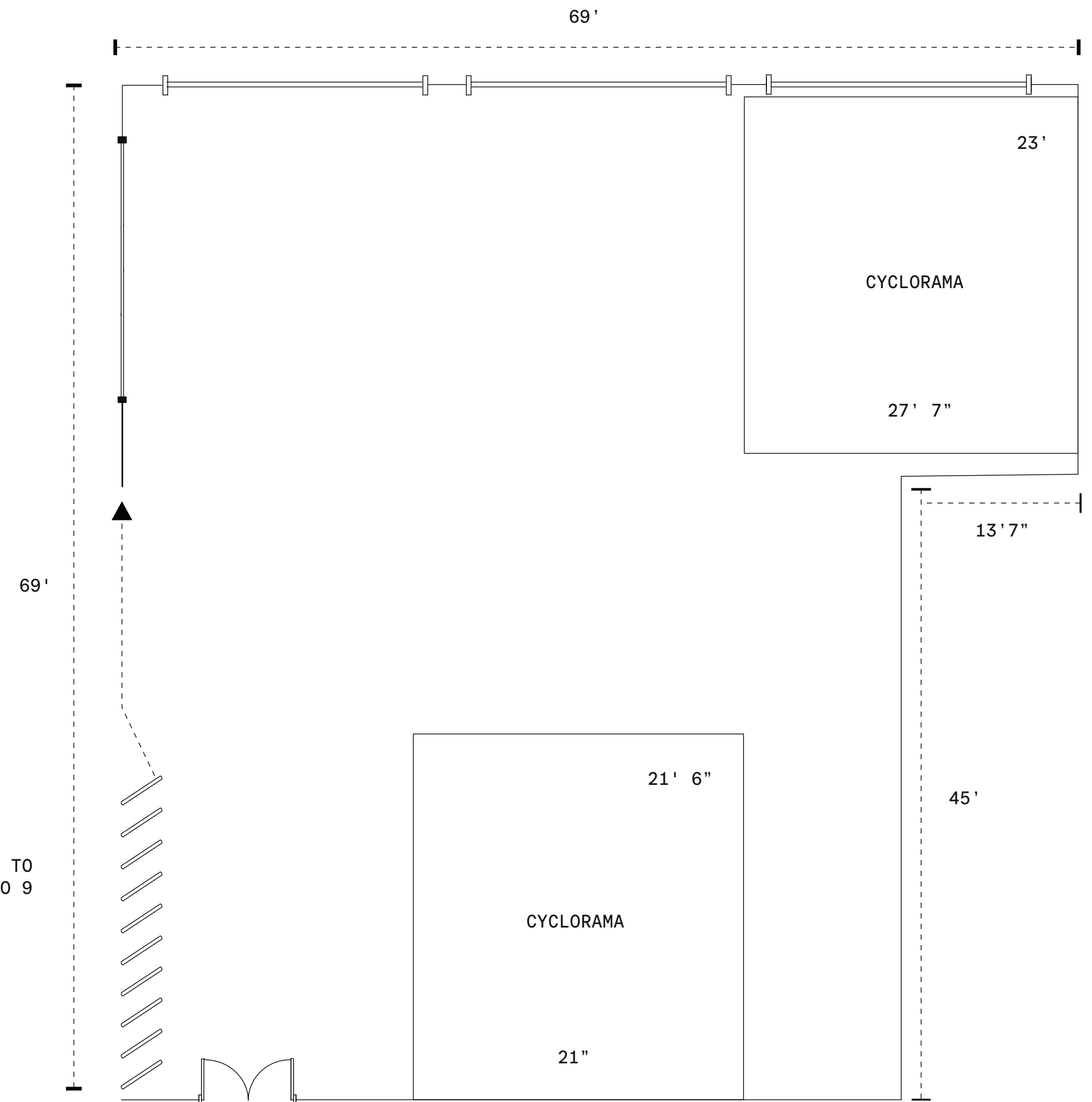

South Facing Window: One, 17'9"W x 10'H / Blackout Capable  
 Retractable Wall to Studio 9: 42'W x 11'H  
 Power: 400 Amp 3 Phase Distributed by Two 200 Amp Camlock Services

# STUDIO 10



SIZE / TYPE

4150sf. / Western Daylight Studio



SPECS

Dimensions: 69'W x 69'D x 11'8"H to Beams / 15'-18' Slope of Ceiling  
 East Cyclorama: One Wall, 21'W x 21'6"D x 12'6"H  
 West Cyclorama: One Wall with Return, 23'W x 27'7"D x 13'H to Top of Cove  
 West Facing Windows: Wall of Three, 17'9"W x 10'H / Blackout Capable

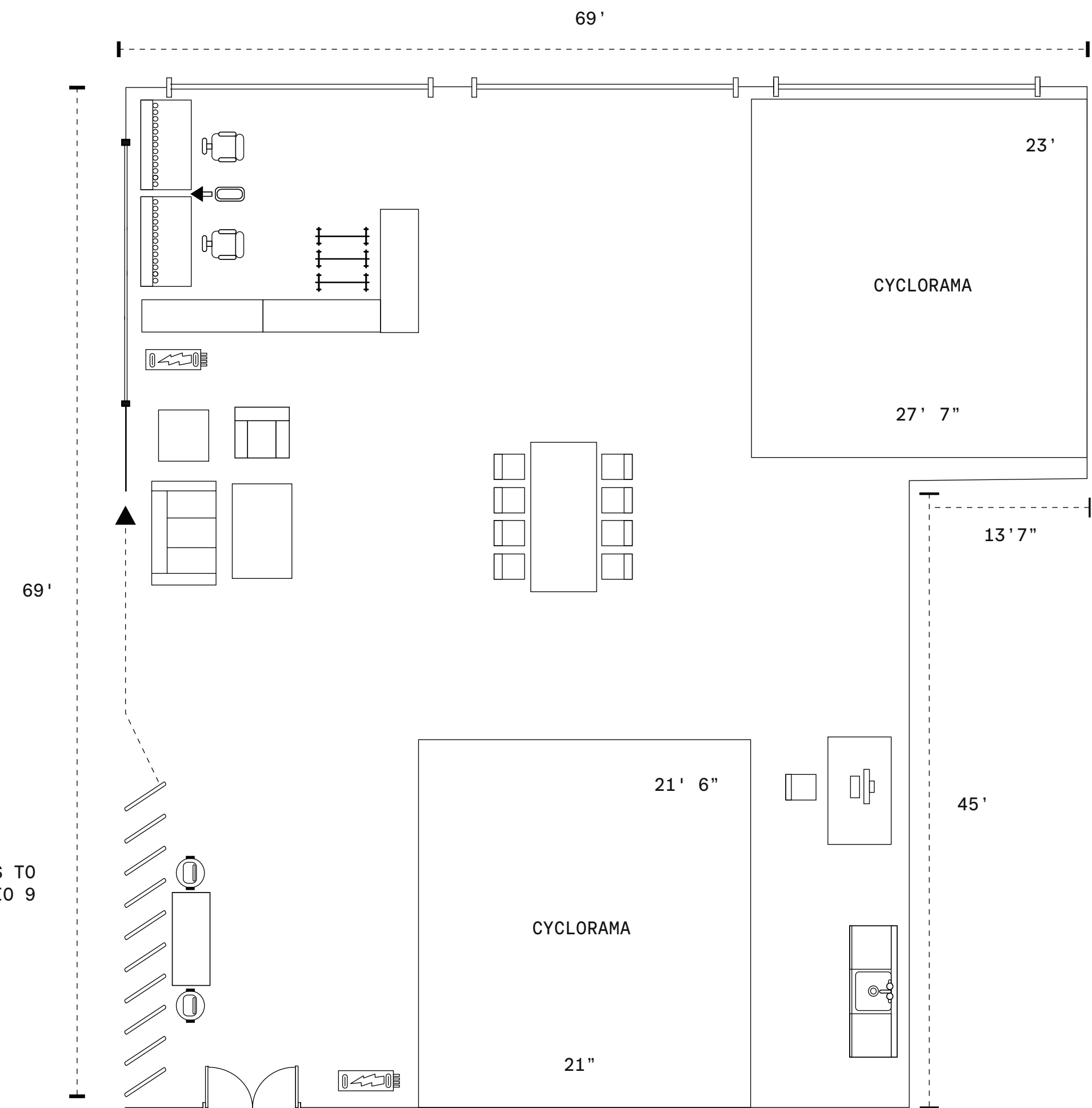

South Facing Window: One, 17'9"W x 10'H / Blackout Capable  
 Retractable Wall to Studio 9: 42'W x 11'H  
 Power: 400 Amp 3 Phase Distributed by Two 200 Amp Camlock Services