

STUDIO 9

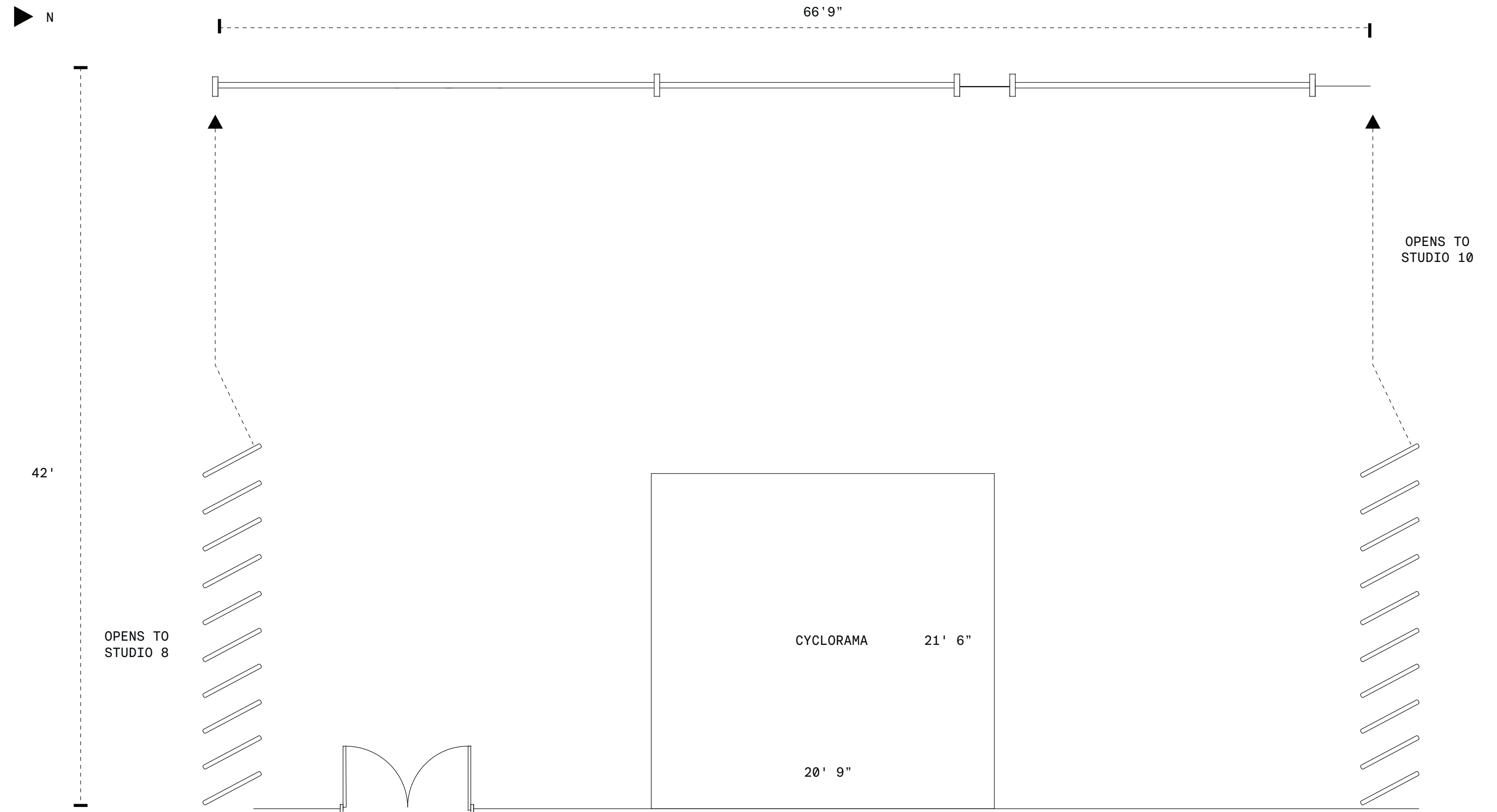

SIZE / TYPE

2800sf. / Western Daylight Studio



SPECS

Dimensions: 66'9"W x 42'D x 11'8"H to Beams / 15'-18' Slope of Ceiling
 Cyclorama: One Wall, 20'9"W x 21'6"D x 16'H
 West Facing Windows: Wall of Three, 17'9"W x 10'H / Blackout Capable

Retractable Wall to Studios 8 + 10: 42'W x 11'H
 Power: 200 Amp 3 Phase Distributed by Camlock Service

STUDIO 9



SIZE / TYPE

2800sf. / Western Daylight Studio

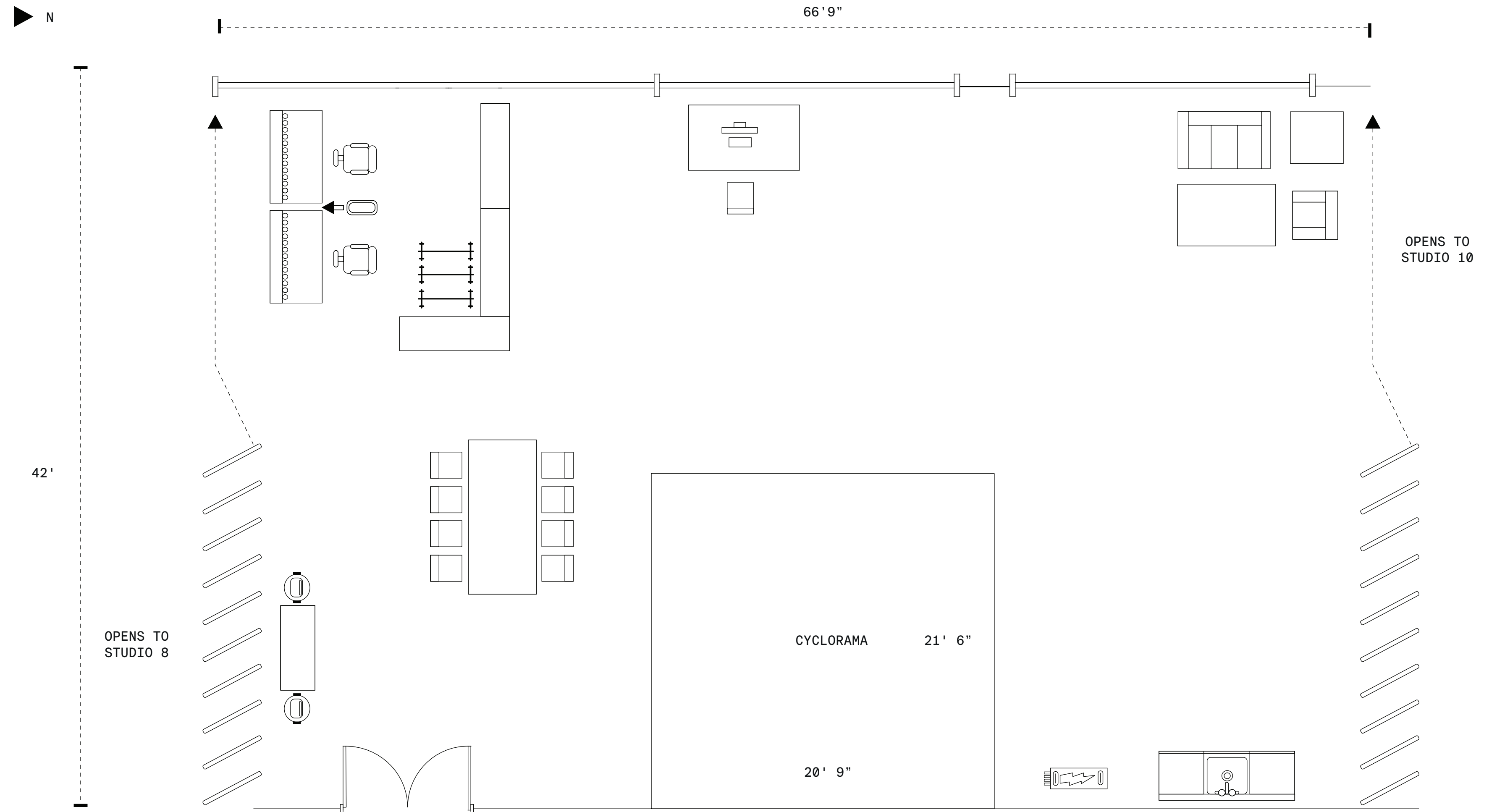

SPECS

Dimensions: 66'9"W x 42'D x 11'8"H to Beams / 15'-18' Slope of Ceiling
 Cyclorama: One Wall, 20'9"W x 21'6"D x 16'H
 West Facing Windows: Wall of Three, 17'9"W x 10'H / Blackout Capable

Retractable Wall to Studios 8 + 10: 42'W x 11'H
 Power: 200 Amp 3 Phase Distributed by Camlock Service